

SEATING (excl. Chancel)

Nave and aisles = 120
Creche/mtg rm = 4
North Transept = 10
South Transept = 5
Barnwell Chapel = 4

Total = 143
[includes chairs with arms = 31]

plus Lady Chapel = 24

plus 157 chairs stacked in Barnwell Chapel

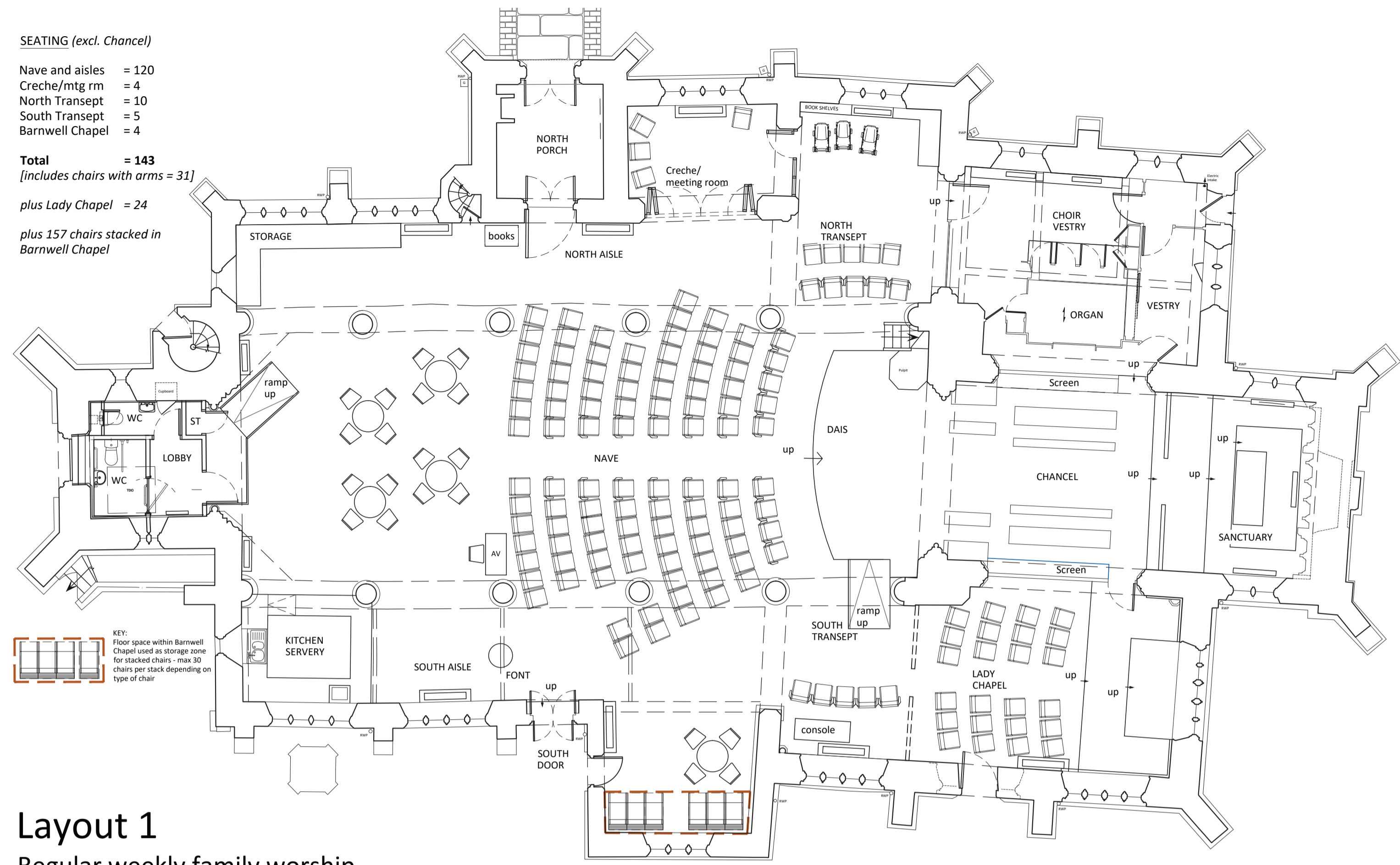

Layout 1
Regular weekly family worship

SEATING (excl. Chancel)

Nave and aisles = 230
Creche/mtg rm = 8
North Transept = 25
South Transept = 10
Barnwell Chapel = 15

Total = 288
[includes chairs with arms = 31]

plus Lady Chapel = 24

empty dollies removed from church

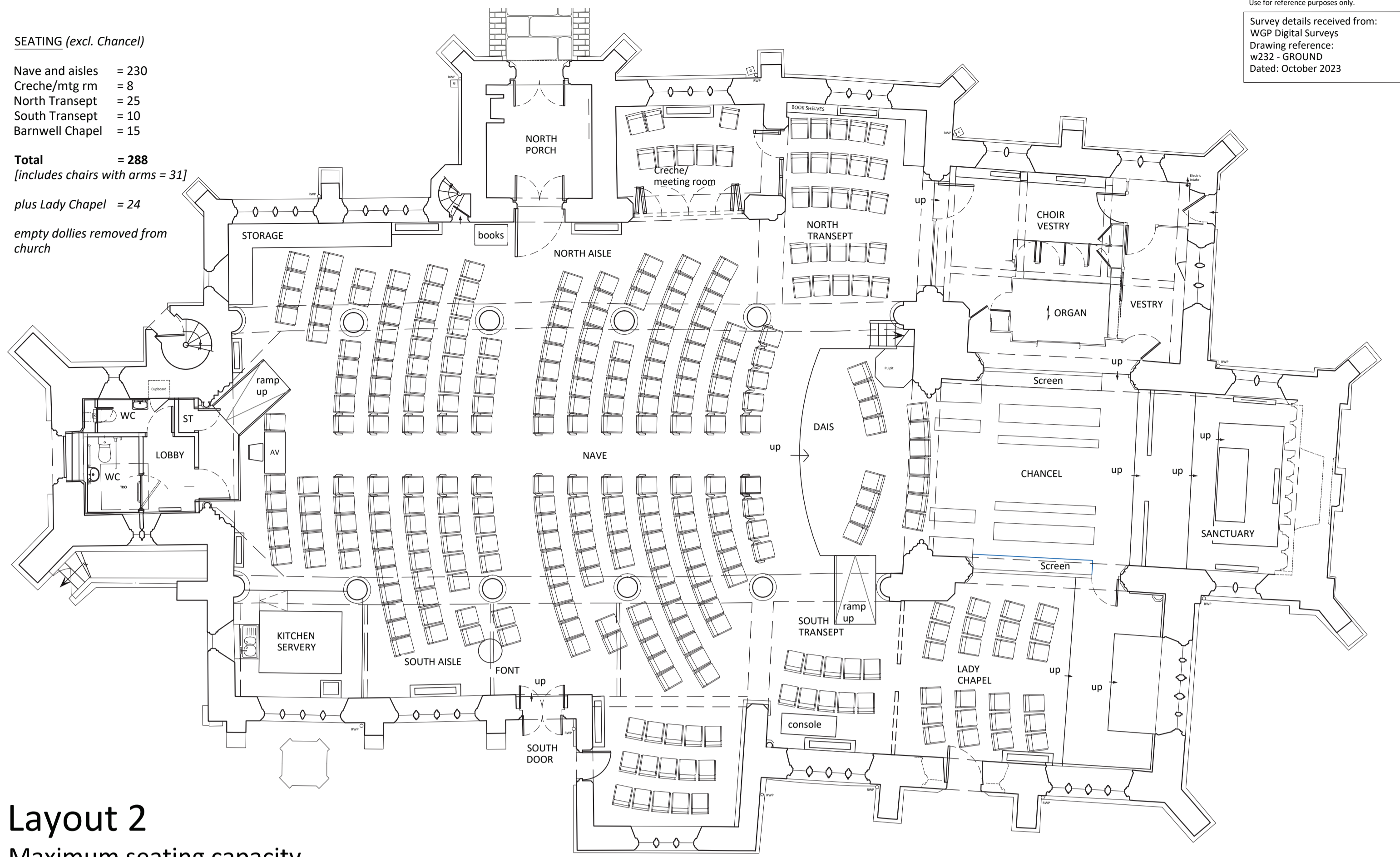

Layout 2
Maximum seating capacity

SEATING (excl. Chancel)

Nave and aisles (radial) = 134
Creche/mtg rm = 4
North Transept = 0
South Transept = 8

Total = 154
[includes chairs with arms = 31]

plus Lady Chapel = 14

plus 150 chairs stacked in Barnwell Chapel

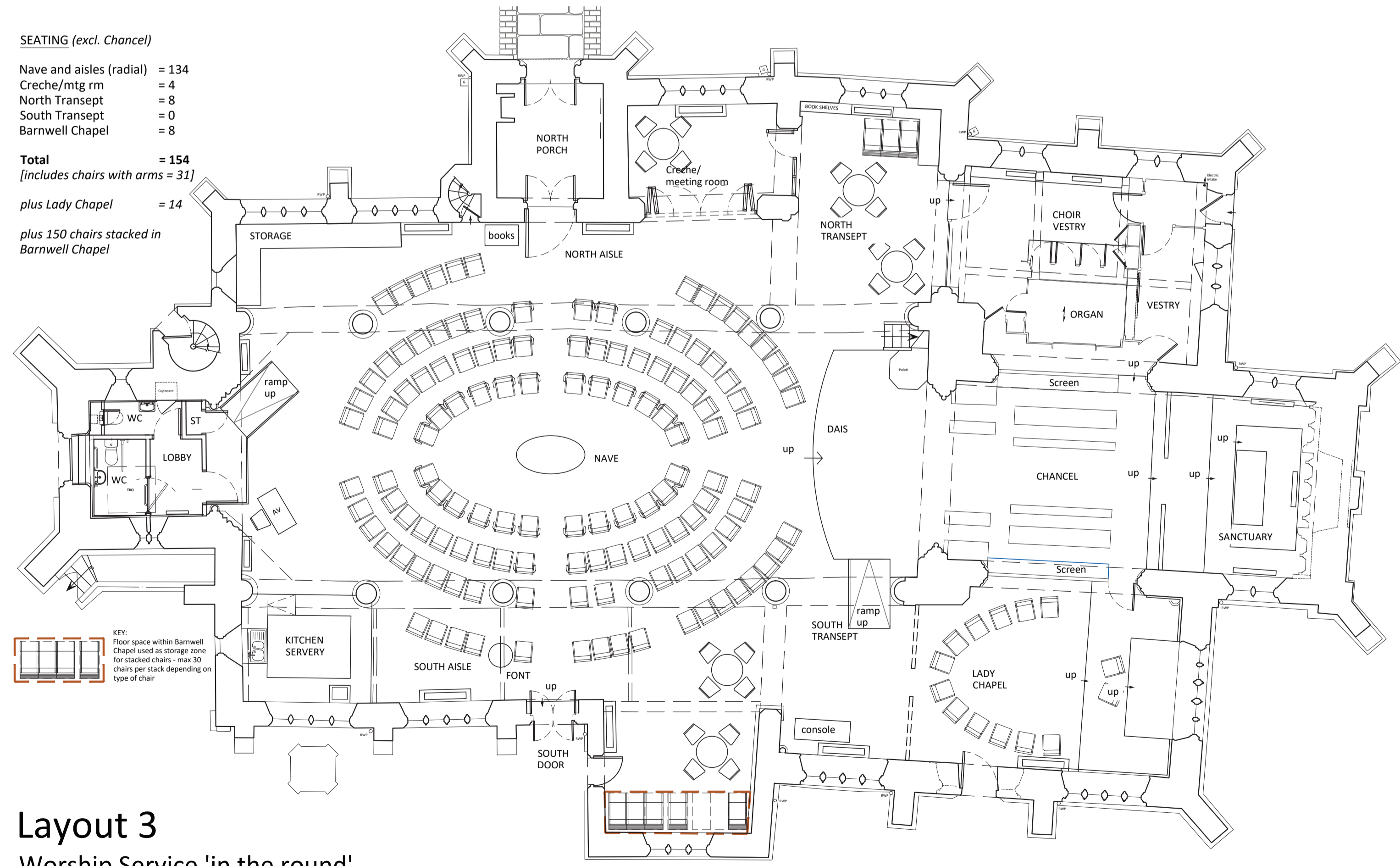

Layout 3
Worship Service 'in the round'

SEATING (excl. Chancel)

Stacked in Barnwell Chapel = 300

plus Lady Chapel = 24

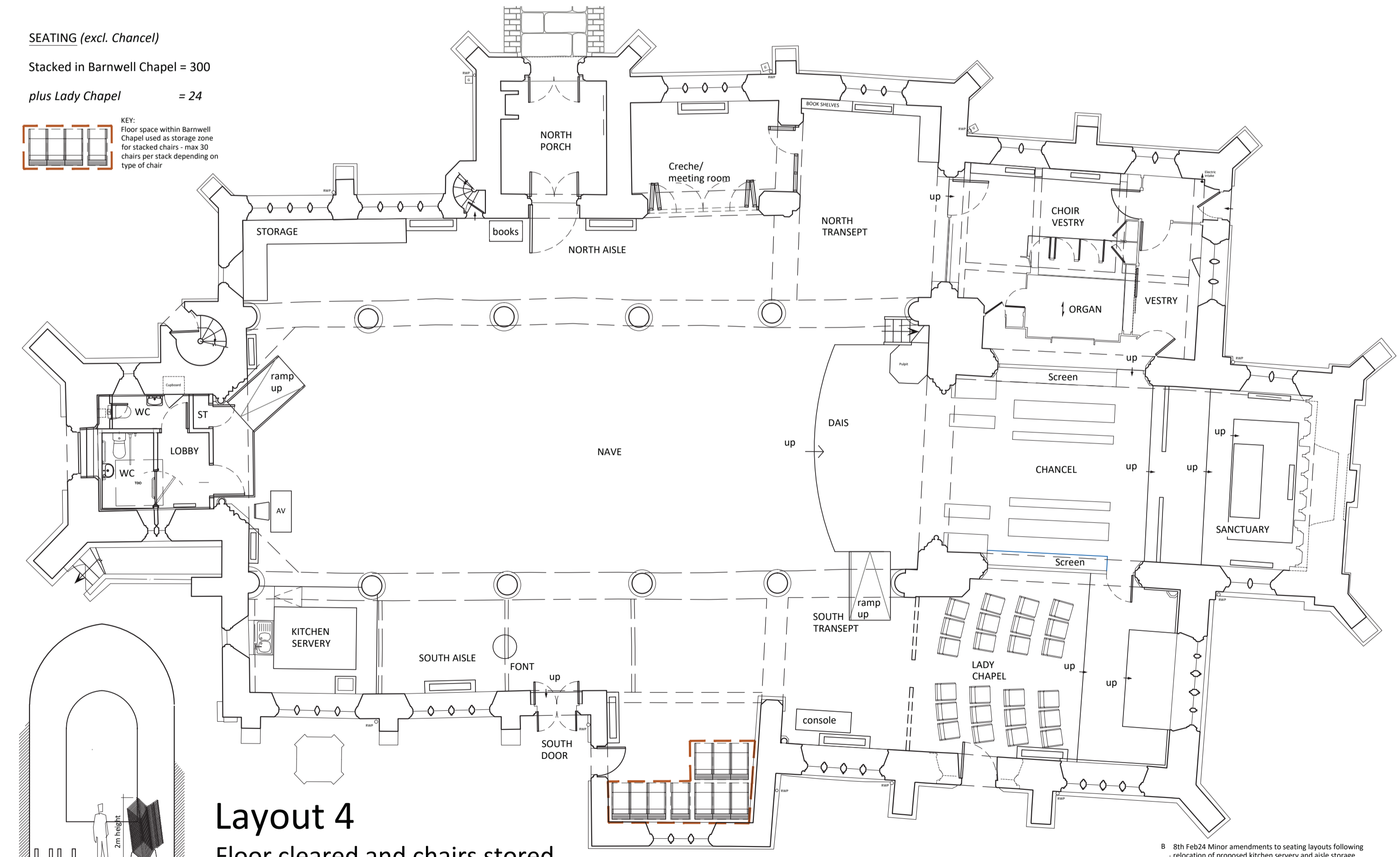

Layout 4
Floor cleared and chairs stored

Internal elevation of south wall of Barnwell Chapel showing height of 30 'Theo' chairs stacked on a dolly in relation to window reveal for discussion purposes.

